

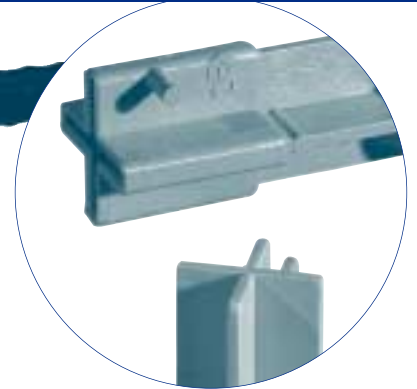

deck chairs

**EASILY CLIPS TO
TOP REO**

**TOP AND BOTTOM REO
Supported with one chair**



description

The revolutionary new Deck chair has been designed as a replacement for wire reo supports in suspended decks, large precast and tilt-up applications. The new chairs are more economical, lighter and have no rust problems.

The chairs are strong and stable, tests to date have exceeded loads of 350kg. The bases are designed to fit through a 100mm aperture for easy installation, minimal exposure and are coloured grey.

Now the one chair can be used to support both reinforcement layers, the bases can support the bottom reo and the shaft clips conveniently to the top reo saving time and money. (The shaft clips will crush down to allow large bars up to 28mm to sit in the saddle.)

Note: When supporting both top and bottom mesh, the corresponding wires between each layer must be offset by the shaft thickness (35mm).

ideal for

- Suspended Decks
- Tilt-Up Panels
- Precast Panels

size availability

Top reo heights of 90 to 220mm in 10mm increments.

- 100mm base provides bottom reo covers of 25 and 30mm.
- 30mm base provides bottom reo covers of 25, 30 and 40mm.

* For Covers between 40 and 90mm, the Heavy Duty Range is available.

**STRONG, STABLE
Tested to loads of 350kg**

MINIMAL EXPOSURE

**FITS THROUGH
100mm APERTURE**

**BASE
CONCRETE GREY**





deck chairs

DIMENSIONS

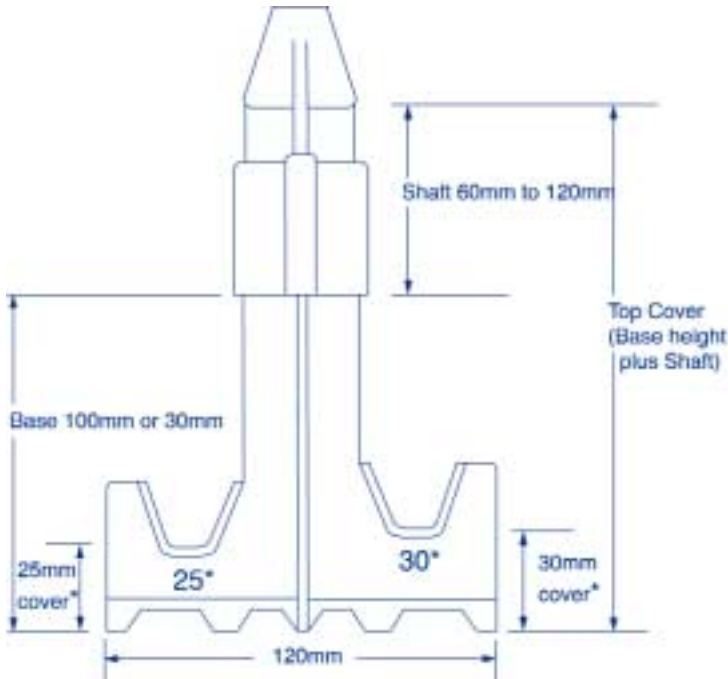

DECK CHAIR ASSEMBLED
(100 mm base depicted above)

*NOTE: 30mm base also provides 40mm bottom cover.

Order Code	Height	Mass Per Bag kg
DECK CHAIRS ASSEMBLED (30mm Base plus shaft.)		
BDK90	90 30+60	4.0
BDK100	100 30+70	4.1
BDK110	110 30+80	4.2
BDK120	120 30+90	4.3
BDK130	130 30+100	4.4
BDK140	140 30+110	4.5
BDK150	150 30+120	4.6
DECK CHAIRS ASSEMBLED (100mm Base plus shaft.)		
BDK160	160 100+60	5.1
BDK170	170 100+70	5.2
BDK180	180 100+80	5.3
BDK190	190 100+90	5.4
BDK200	200 100+100	5.5
BDK210	210 100+110	5.6
BDK220	220 100+120	5.7

All dimensions are nominal and expressed in millimetres.

Bases and shafts are available separately in bags of 100 or assembled in bags of 50.

TYPICAL APPLICATIONS



45 Macbeth Street, Braeside, Victoria 3195
Telephone: (61 3) 9586 7600
Facsimile: (61 3) 9580 1766
email: modfix@modfix.com.au
www.modfix.com.au

